



4 Inch Downlight

## SECTION 1: GENERAL DESCRIPTION (FIXTURE AND DRIVER)

<b>Model Number:</b>	<b>VOL-4DL-006-CW</b>
<b>Size:</b>	<b>4 INCH</b>
<b>Voltage:</b>	<b>85-277V</b>
<b>Power:</b>	<b>6W</b>
<b>Hue:</b>	<b>Cool White</b>
<b>Material:</b>	<b>Aluminum, Polymethyl Methacrylate</b>
<b>Light Output:</b>	<b>550 Lumens</b>
<b>Beam Angle:</b>	<b>120 Degrees</b>
<b>Correlated Colour Temperature:</b>	<b>6000-6500K</b>
<b>Fixture Life span:</b>	<b>50,000 hours</b>
<b>IP Rating:</b>	<b>IP 30</b>
<b>CRI:</b>	<b>&gt;70</b>
<b>Power Factor</b>	<b>0.9</b>

## SECTION 2: CERTIFICATIONS MET

1. UL Listing: Underwriters Laboratory testing for dependable reliability and lifespan of fixture
2. RoHS Certification: Restriction of Hazardous Substances- Ensuring no toxic chemicals or materials are used in the manufacture.
3. CE Certification: (Conformity European) to ensure that this product can be within the strictest standards of Europe.

## SECTION 3: LIGHT SOURCE DESCRIPTION (LED CHIP)

<b>LED type</b>	<b>2835 SMD EPISTAR</b>
<b>Number of LEDs</b>	<b>30</b>

## SECTION 4: COMPARABLE OLDER LIGHT SOURCE

4 Inch LED Downlight	4 Inch Metal Halide Downlight
550 Lumen	450 Lumen
6 Watt	15 Watt Power
50,000 hour lifespan	200 Hour Lifespan
Withstands Voltage Surges	Filament destroyed with small voltage surges
Available in Warm and Cool	Only Available in Warm

## SECTION 5: INSTALLATION DETAILS

①	make a hole
②	connect the power wire
③	push spring
○	Driver

A	Wall
B	Spring
C	LED lamp
D	Driver

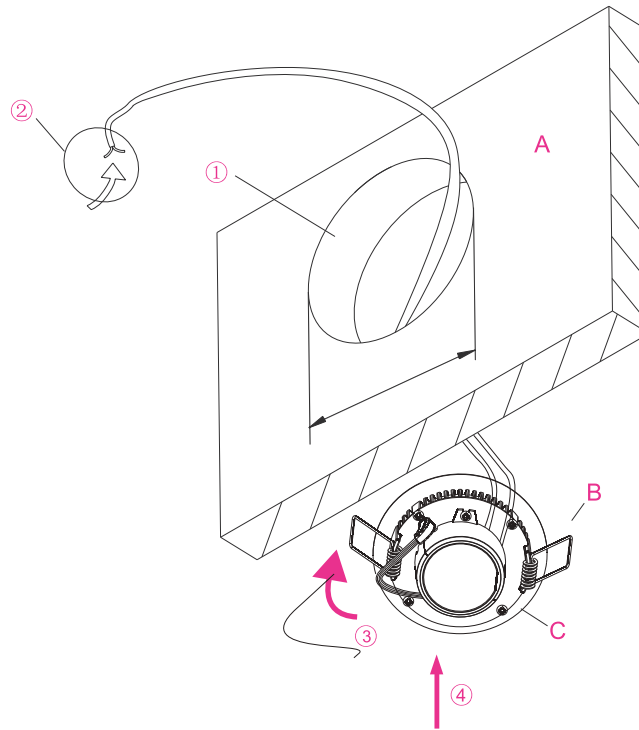

# Luminous Intensity Distribution Curve

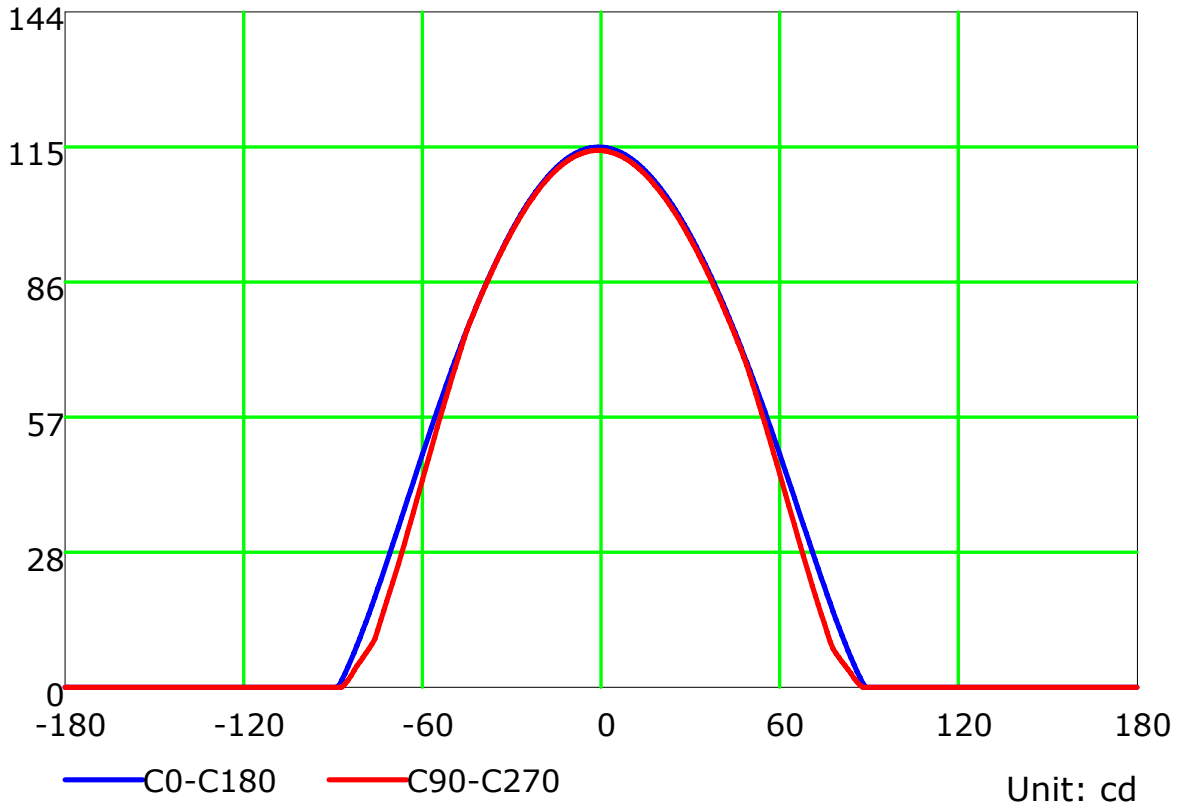
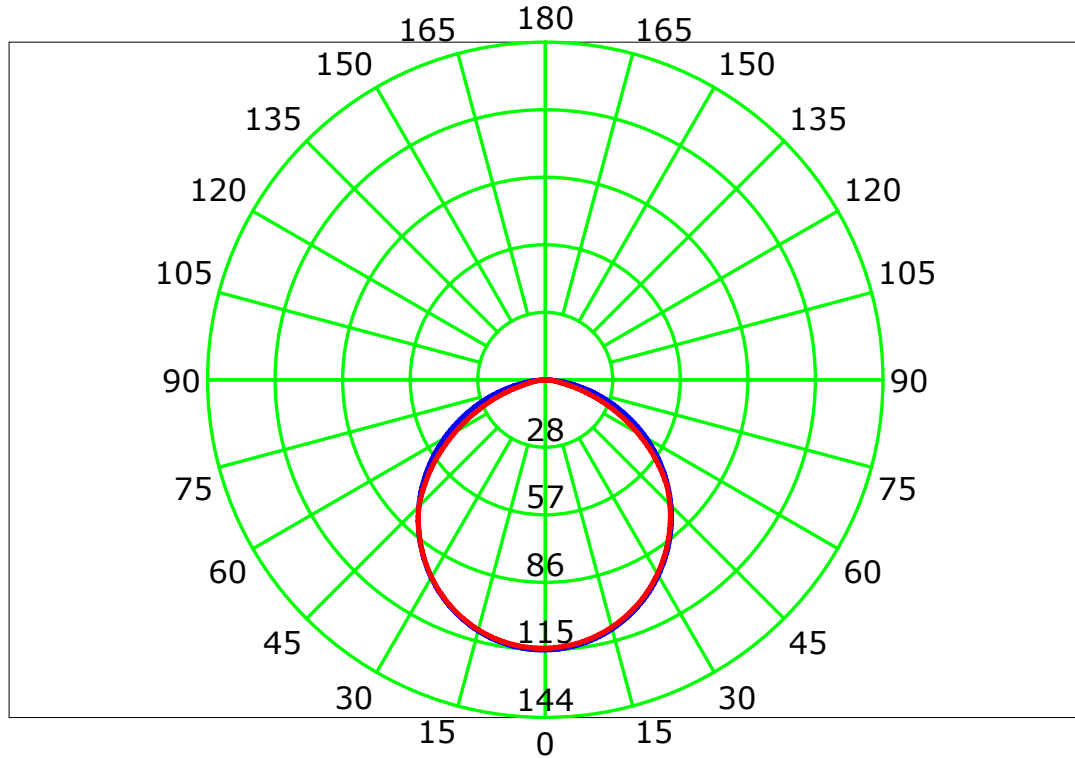

C Plane (°):0.0-360.0: 45.0  
 Test Lab:  
 Test Type: TYPE C  
 Temperature: 27  
 Operator:

Gamma Plane (°):0.0-180.0:1.0  
 Test Device: GPM-1600  
 Distance: 6.495 m  
 Humidity: 67  
 Inspector:

# Luminous Intensity Distribution Curve(cd/klm)

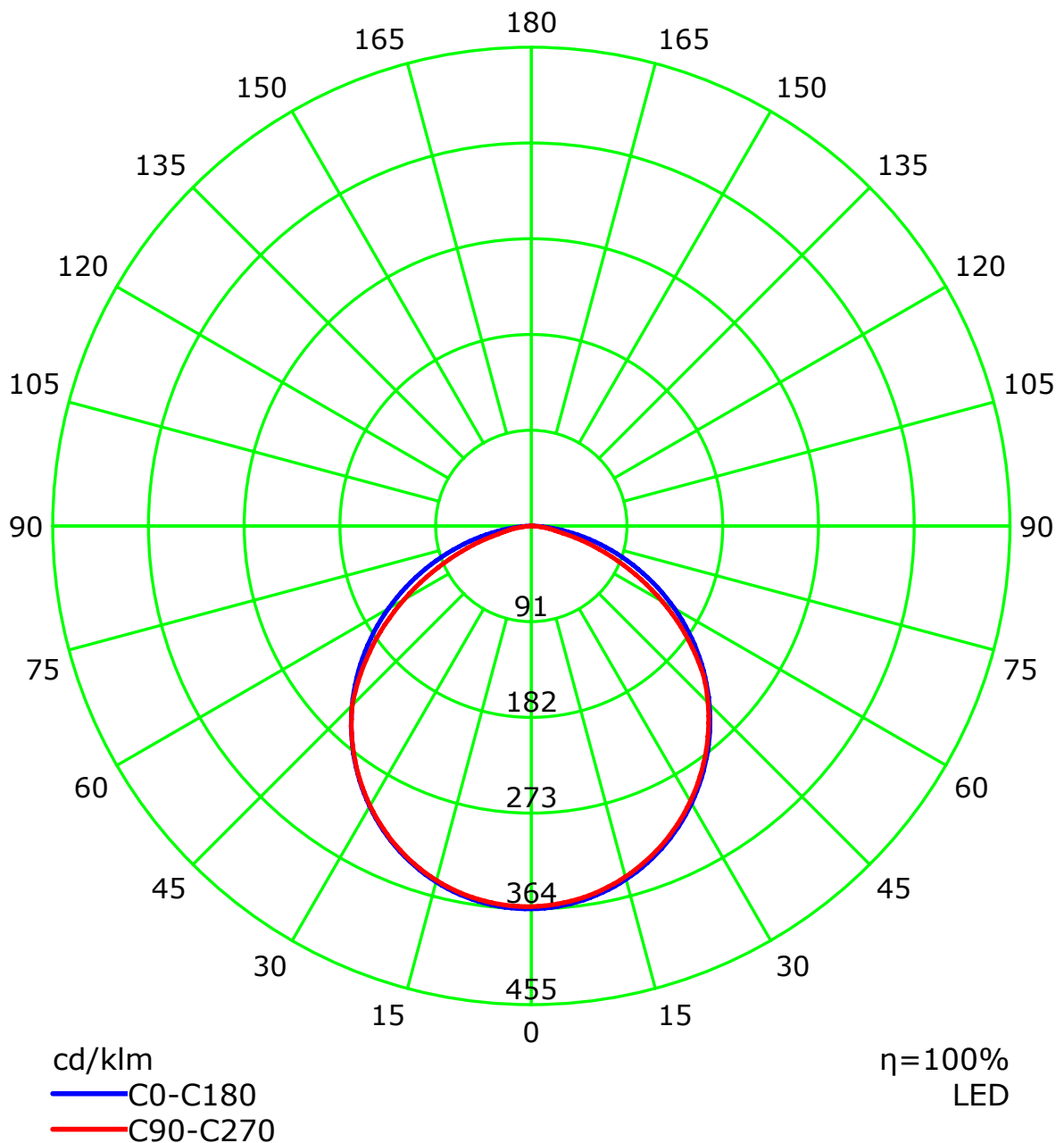

C Plane (°):0.0-360.0: 45.0  
 Test Lab:  
 Test Type: TYPE C  
 Temperature: 27  
 Operator:

Gamma Plane (°):0.0-180.0:1.0  
 Test Device: GPM-1600  
 Distance: 6.495 m  
 Humidity: 67  
 Inspector:

# Isocandela (rectangle)

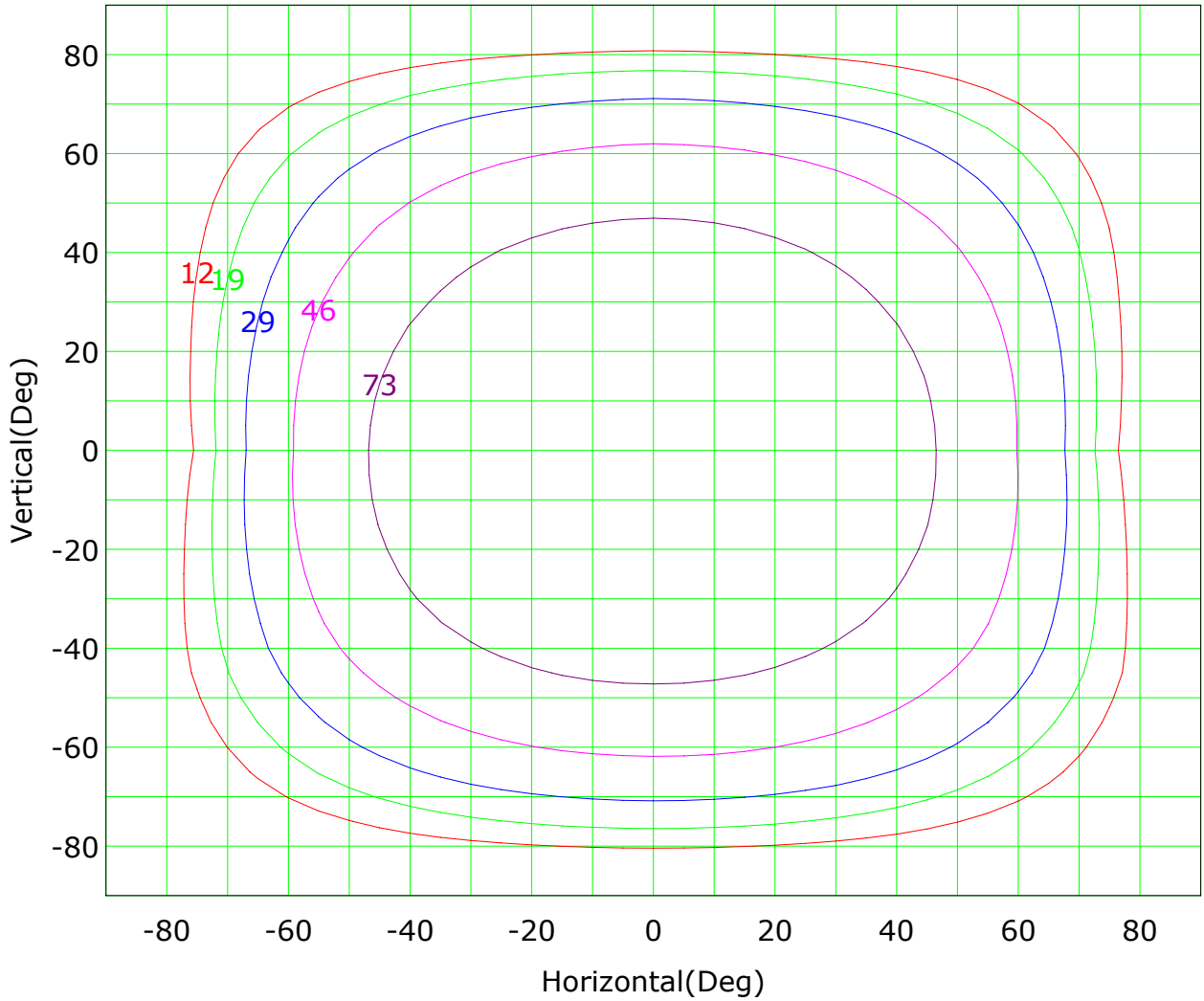

Imax (100%): 116 cd

- |           |       |           |        |
|-----------|-------|-----------|--------|
| — ( 10%): | 12 cd | — ( 16%): | 19 cd  |
| — ( 25%): | 29 cd | — ( 40%): | 46 cd  |
| — ( 63%): | 73 cd | — (100%): | 116 cd |

C Plane (°):0.0-360.0: 45.0  
 Test Lab:  
 Test Type: TYPE C  
 Temperature: 27  
 Operator:

Gamma Plane (°):0.0-180.0:1.0  
 Test Device: GPM-1600  
 Distance: 6.495 m  
 Humidity: 67  
 Inspector:

# Illuminance at a Distance

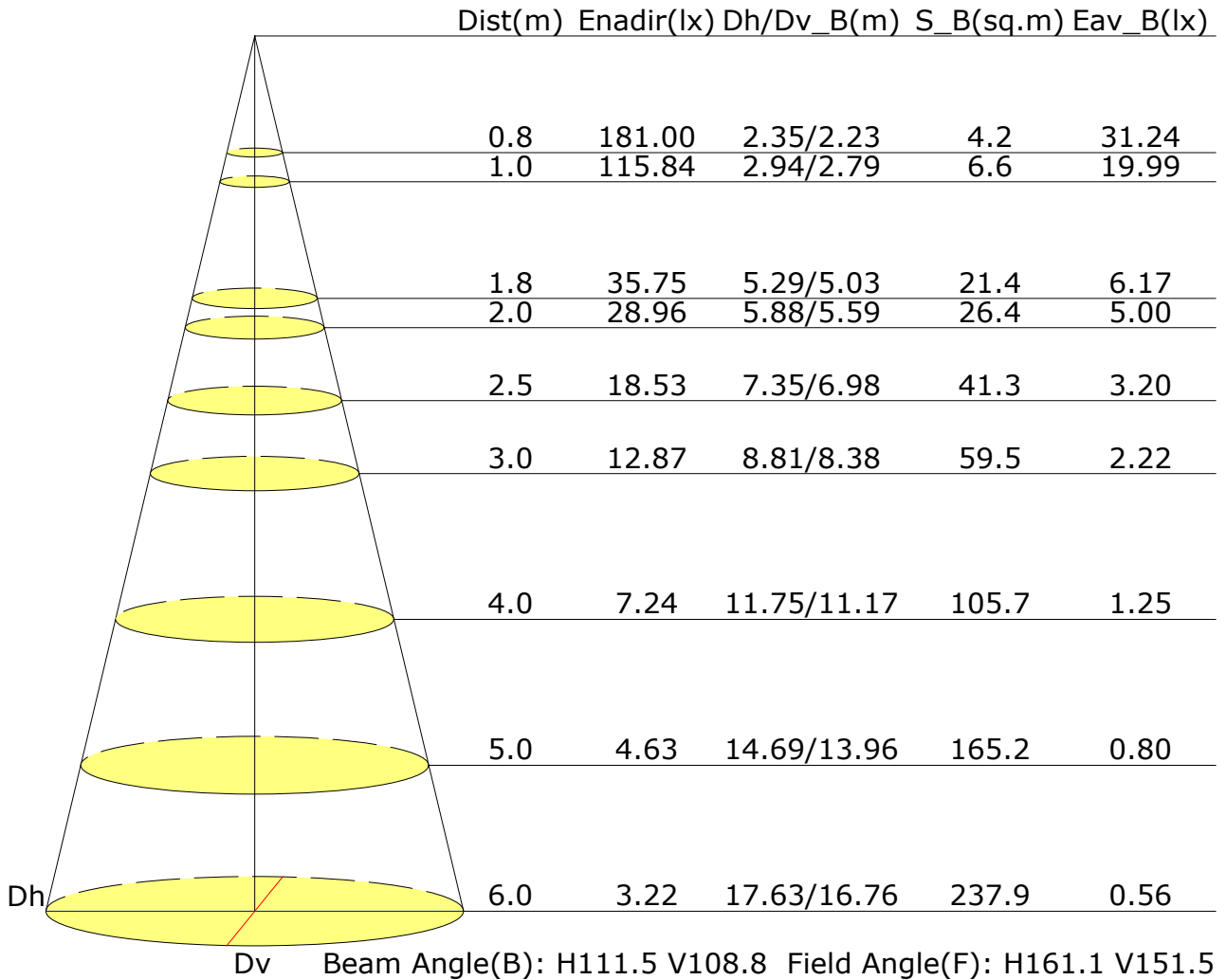

C Plane (°):0.0-360.0: 45.0  
 Test Lab:  
 Test Type: TYPE C  
 Temperature: 27  
 Operator:

Gamma Plane (°):0.0-180.0:1.0  
 Test Device: GPM-1600  
 Distance: 6.495 m  
 Humidity: 67  
 Inspector:

# Vertical IsoLux Plot

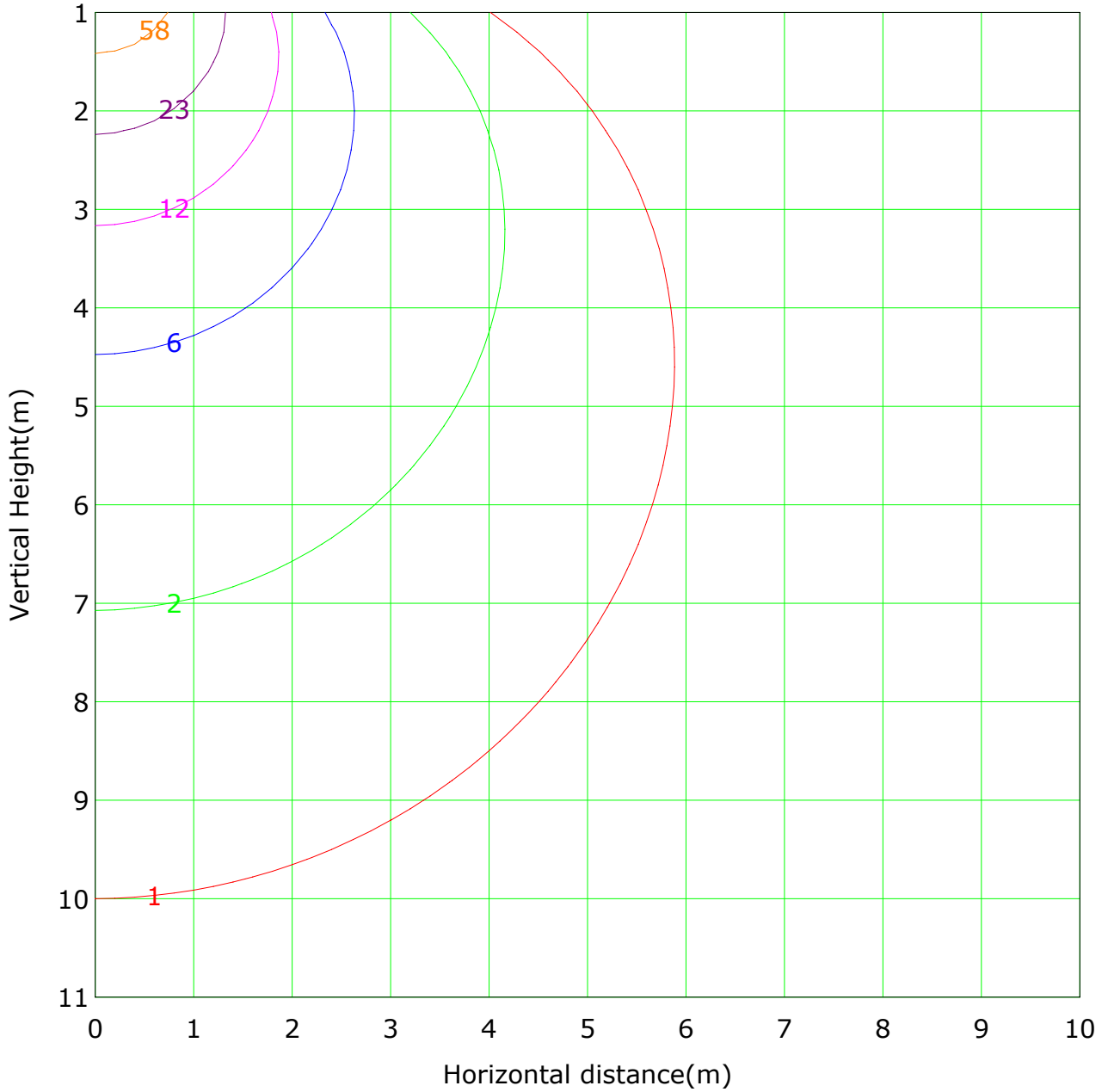

Lowest(m): 1.0m    Highest(m): 11.0m    Max Lux: 115.8 lx  
 ( 1%): 1.2 lx                      ( 2%): 2.3 lx  
 ( 5%): 5.8 lx                        ( 10%): 11.6 lx  
 ( 20%): 23.2 lx                      ( 50%): 57.9 lx  
 (100%): 115.8 lx

C Plane (°):0.0-360.0: 45.0  
 Test Lab:  
 Test Type: TYPE C  
 Temperature: 27  
 Operator:

Gamma Plane (°):0.0-180.0:1.0  
 Test Device: GPM-1600  
 Distance: 6.495 m  
 Humidity: 67  
 Inspector:

## The Average Illuminance Effective Figure

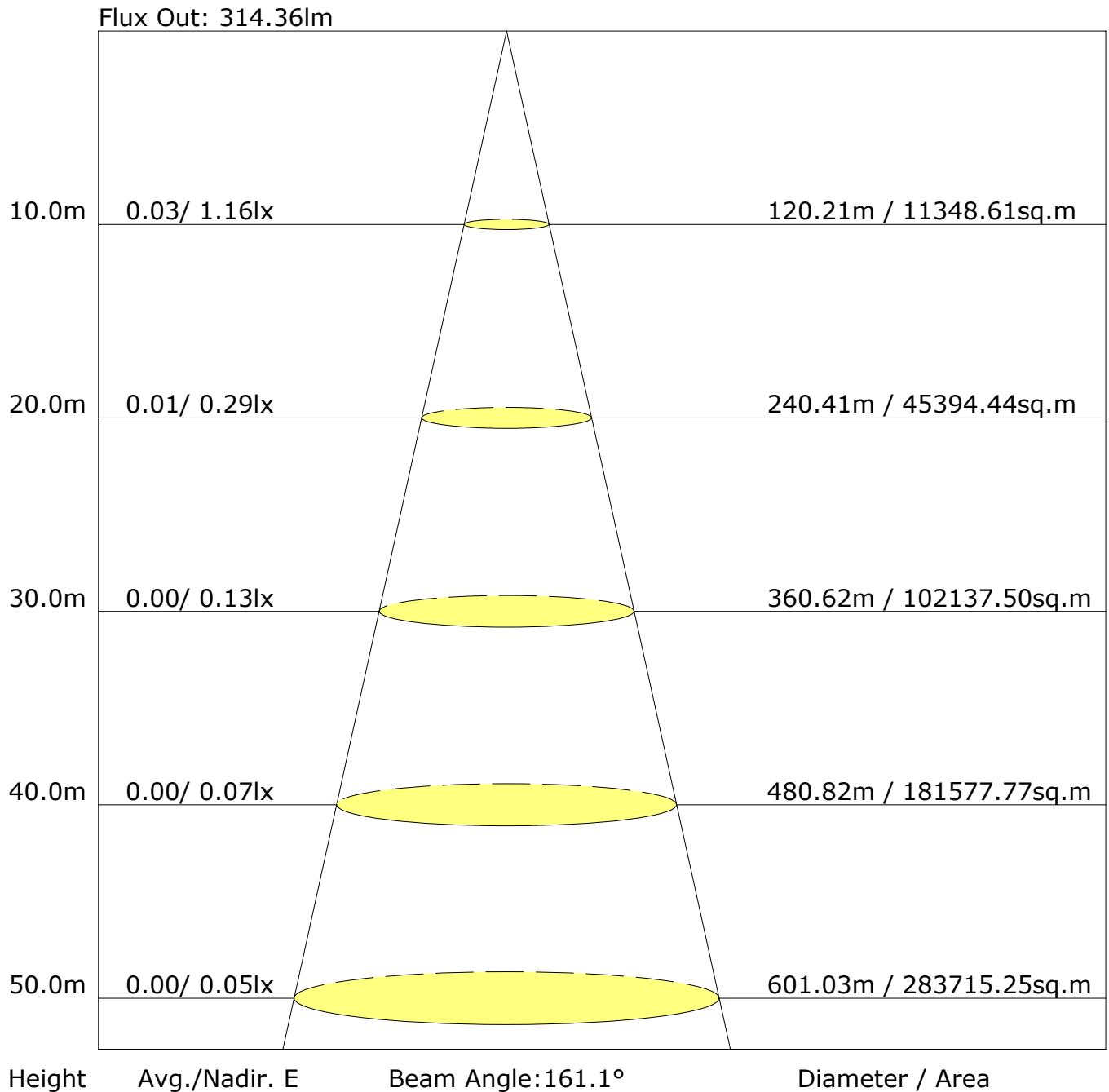

C Plane (°):0.0-360.0: 45.0  
 Test Lab:  
 Test Type: TYPE C  
 Temperature: 27  
 Operator:

Gamma Plane (°):0.0-180.0:1.0  
 Test Device: GPM-1600  
 Distance: 6.495 m  
 Humidity: 67  
 Inspector: